

GM 5-9

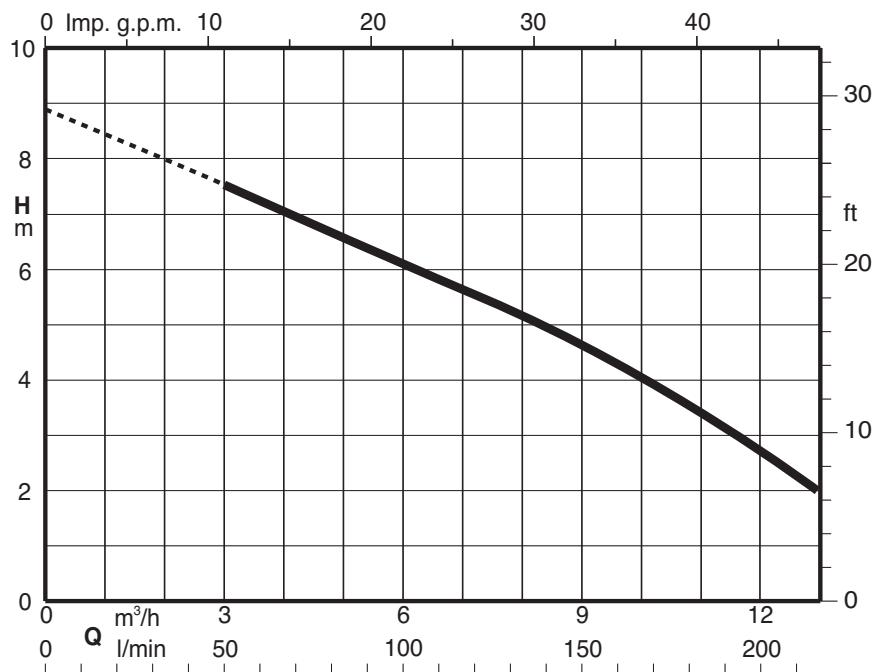

Coverage chart $n \approx 2800$ rpm



Submersible drainage pump

Construction

Submersible drainage pump constructed with composite polymers developed especially for this product.

Double shaft seal with oil chamber.

Small dimensions and great performance, for use in a wide variety of applications, for flow rates up to 217 litres per minute.

With float switch for automatic start and stop.

Applications

For clean water with suspended solids up to a diameter of 5 mm.

For draining flooded rooms or tanks.

Extraction of water from ponds, flowing water or pits for collection of rain water.

For irrigation.

Operating conditions

Maximum liquid temperature for prolonged use: 35 °C (with immersed motor).

Immersion depth: 5 m max.

Motor

2-pole induction motor, 50 Hz ($n \approx 2800$ 1/min).

Single-phase 230 V $\pm 10\%$, with thermal protector.

Incorporated capacitor

Cable H05RN-F, 3G0,75 mm²: with plug, length 10 m, 245IEC57, according to EN 60335-2-41 for pumps up to 10 kg.

Insulation class F.

Protection IP 68.

Materials

Components	Materials
Pump casing	PP+GF30
Impeller	PA66+GF30
motor jacket	Chrome-nickel steel 1.4301 EN 10088 (AISI 304)
Pump jacket	PP+GF30
Filter	PP+GF30
Handle	PP+GF30
Shaft	Acero C45E EN 10083-2
Mechanical seal	Graphite/Ceramic/NBR

Performance $n \approx 2800$ rpm

Single-phase

Model	230V A	P2		P1 kW	Q = Flow							
		kW	HP		m ³ /h	l/min	0	1,2	3	6	9	12
GM 5-9	2,4	0,33	0,45	0,55		8,9	8,2	7,6	6,1	4,7	2,8	2

H (m) = Total head

P1: Maximum power input.

P2: Rated motor power output.

H: Total head in m

Dimensions and weights

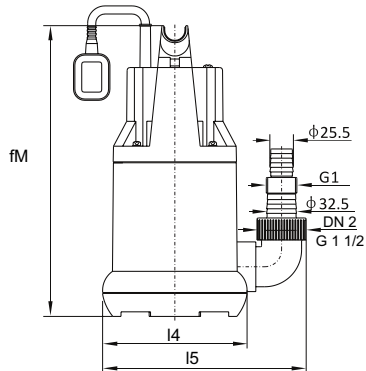

TYPE	DN2	fM	mm				kg Weight
			l4	l5	Lmax	Lmin	
GM 5-9	G 1 1/2	316	157	222	340	120	4.7

Examples of installations

